

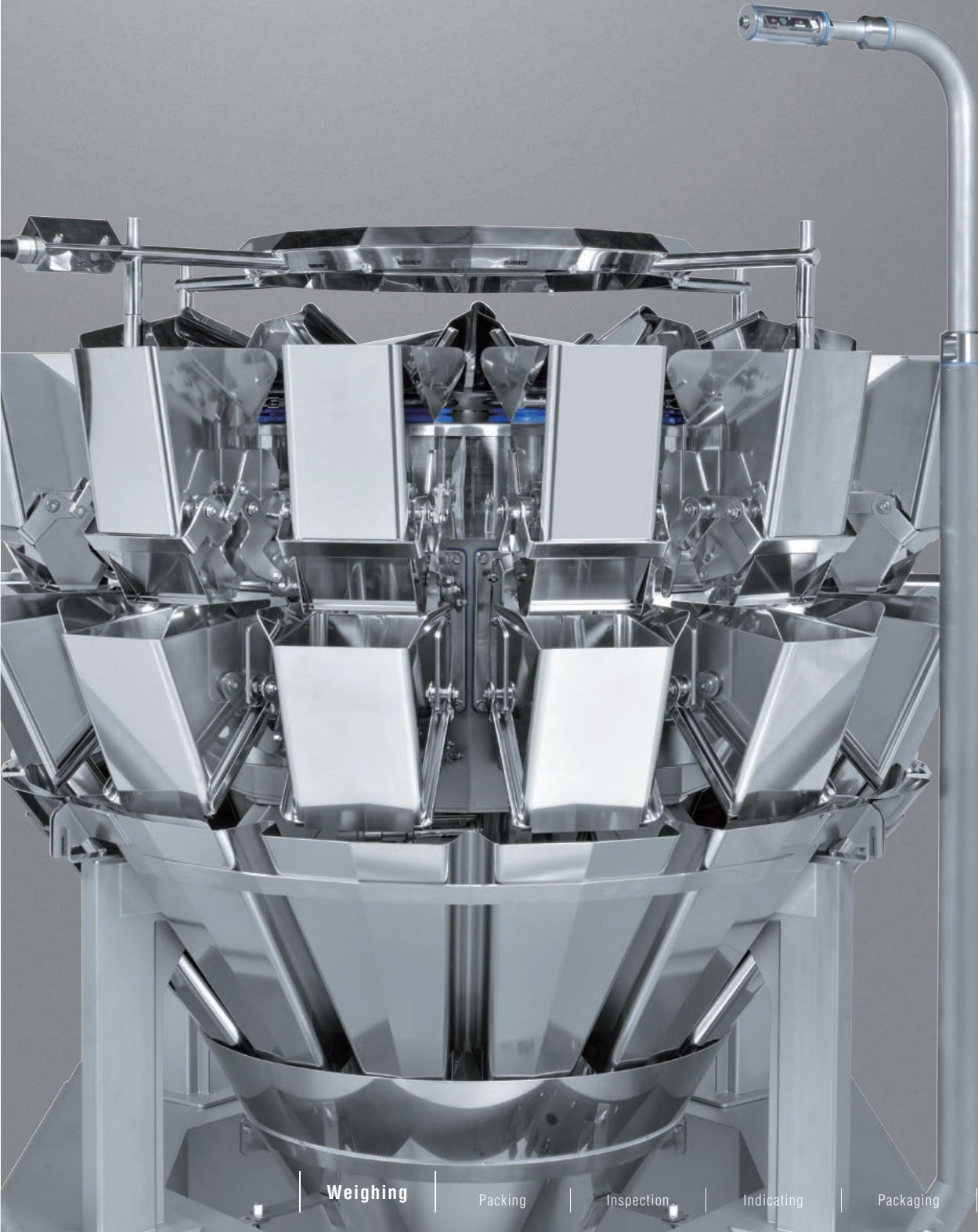

Multihead Weigher

CCW-AS



Weighing

Packing

Inspection

Indicating

Packaging

Unequaled productivity provides solutions to workforce shortages

CCW-AS

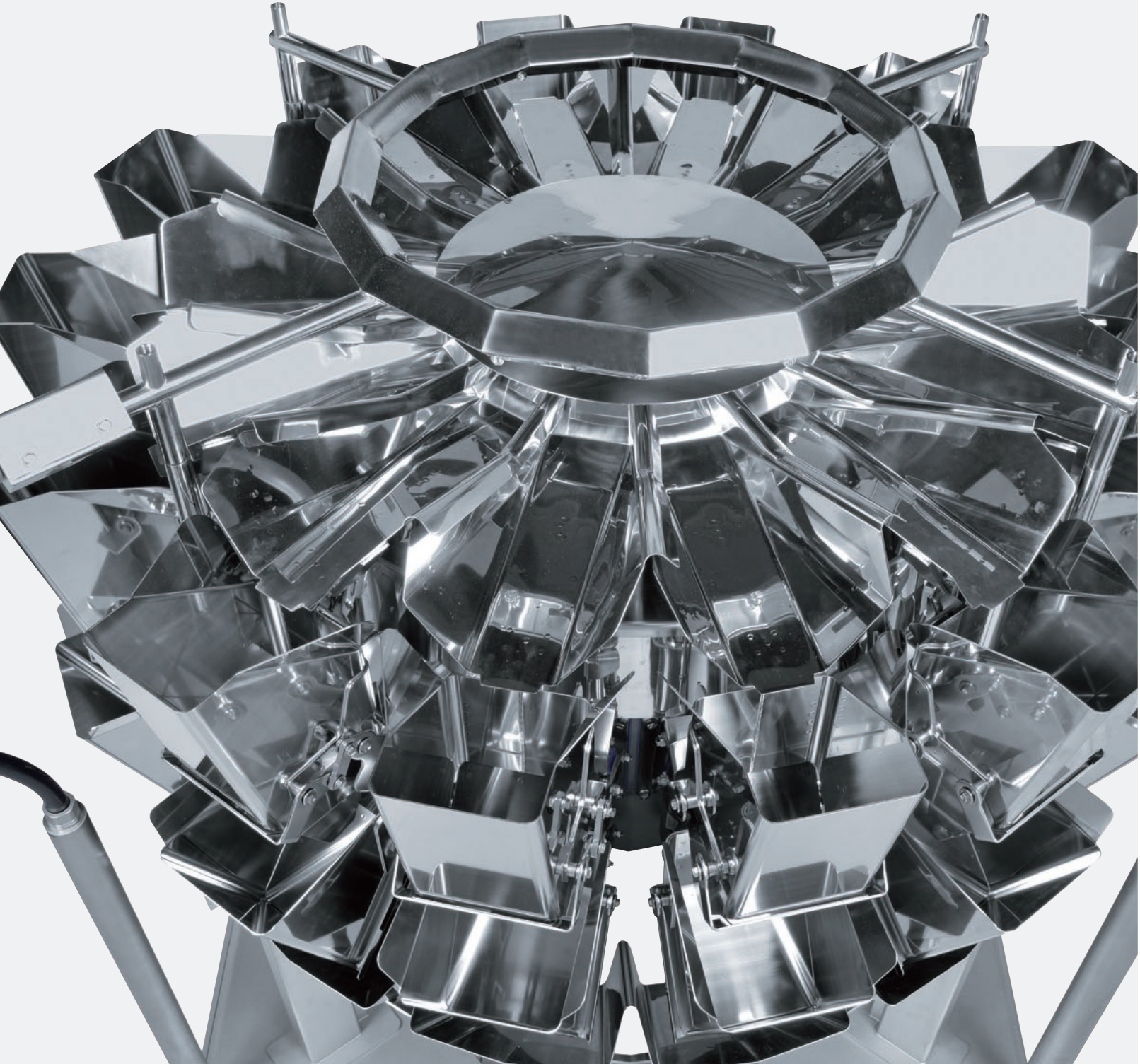

Based on more than 50 years of combination weighing know-how, additional functions to improve productivity

The CCW-AS multihead weigher increases overall equipment effectiveness and reduces workload through line automation.

Ishida continues to evolve as a market leader in multihead weighing, contributing to sustainable objectives and a diverse range of weighing solutions that use the latest weighing technology.

CCW-AS opens a new era for multihead weighing.



Advanced productivity

The fully redesigned electrical platform achieves higher accuracy and efficiency. New features include optical charge control (OCC), automatic adjustment of hopper open/close interval, and XRF-7 to enhance product feeding and maximize production output.

Advanced operation

A redesigned drive unit improves sanitation and allows faster cleaning. Multiple cameras are mounted on the CCW to verify the machine status. It contributes to minimize workload for machine adjustment.

Advanced HMI

A 15.6" color LCD touch panel improves visibility and operability. The HMI is unified with other Ishida equipments for easy integration.

Advanced ecological model

New motor drive control reduces power consumption and contributes to reduced environmental impact. The redesigned feed drive control minimizes noise.

Advanced productivity

New feeder (XRF-7) for optimum feeding

Radial feeders are essential in combination weighing to feed product to pool and weigh hoppers. The newly developed XRF-7 radial feeder has more conveying power for large volumes and sticky products than conventional feeders. By increasing the responsiveness of the feeders, the optimum quantity of product can be delivered to each weigh hopper, resulting in higher efficiency rates with more hoppers available for the combination.

Higher feeding capacity

Increased efficiency

Increased feeding ability while maintaining high conveying accuracy

Feeder response image

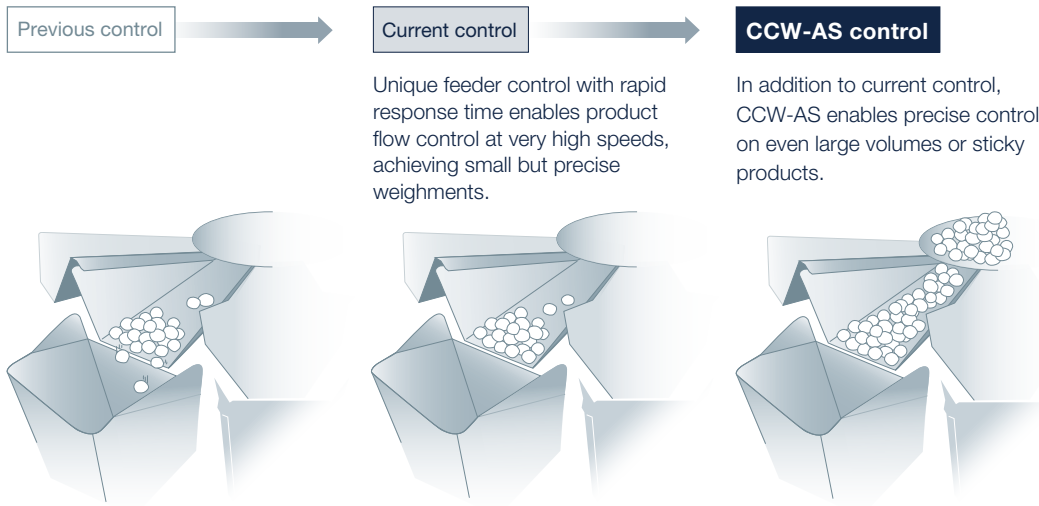

Best yield

New circuit board advances resolution and improves accuracy.

Increase weighing yield

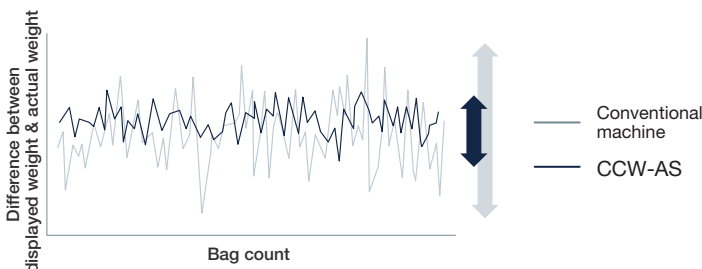

Minimum differences between displayed and actual weight with high weighing accuracy

Automatic adjustment of hopper open/close intervals

CCW-AS utilizes mass data and automatically adjusts the movement timing between hoppers. Even unskilled operators can adjust hopper open/close interval timing with high precision and high operating rates.

Quick automatic optimization

Increased efficiency

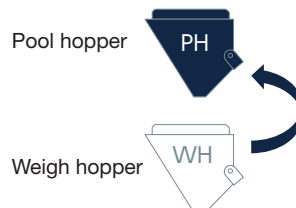

Automatically optimizes hopper open/close intervals to improve production efficiency.

Multi-directional dispersion feeder for stable feeding Option

Product feeding condition on dispersion table is censored and maintained so stable amount of product flows to each trough.

Increased efficiency

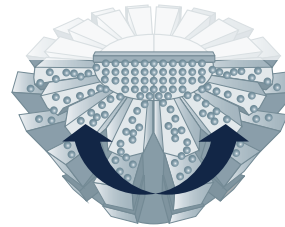

Full control of product amount to each trough

Uneven product feeding

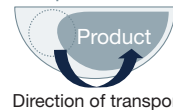

Even product feeding

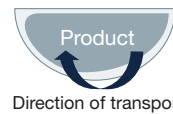

Optical charge control (OCC) for long production Option

High efficiency is achieved in any type of product feature and feeding condition from upstream line. Sensor monitors the product layer on the trough, and feeder drive vibrates to transfer the appropriate amount of product to each hopper.

- ❶ Sensors monitor product layer thickness and indicate an amplitude to feeder for appropriate product volume to hoppers to make target weight. The formula is based on product layer thickness, vibration intensity, and feeding volume.
- ❷ Feeder vibrates at an indicated intensity.
- ❸ Machine learning with feedback of the actual feed quantity supplied to the ❶ sensor control unit.

Machine learning of feeding volume results

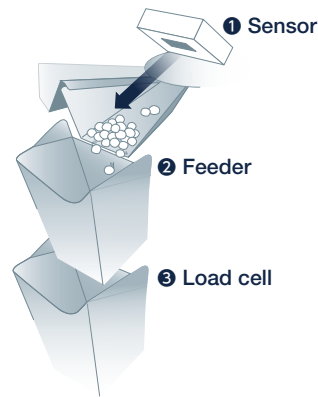

Maintaining best efficiency

Flexible production

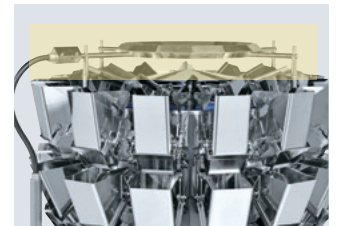

Advanced operation

Easy adjustment by camera monitoring Option

Multiple cameras monitor product condition simultaneously to enhance and to drive increased production efficiency. Live camera footage can be viewed from the operator screen or remotely via an external network.

Save operator's workload



Dispersion camera

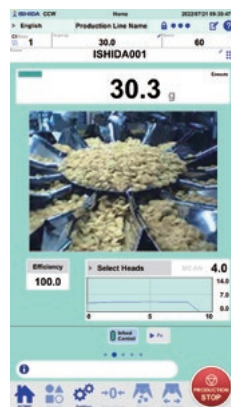

Verify product discharge timing Option

A camera installed in the discharge chute enables constant monitoring of product condition or deposits on the HMI and guides operators to optimize timing setting. Operators can check and adjust production status on the HMI screen.

Minimize operator's workload

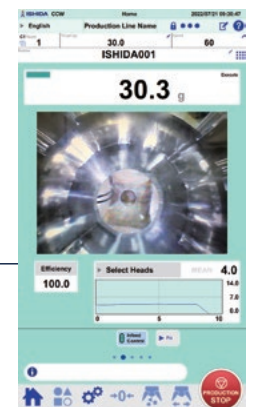
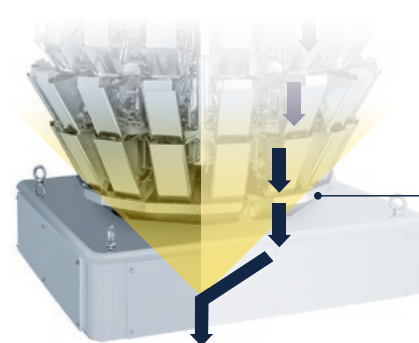

New easy to clean and hygienically designed drive unit

Even after long hours of production, product debris does not stay on drive unit. Smooth surface and wider gap make cleaning easier and improved cleanability ensures hygienic use.

Faster cleaning time

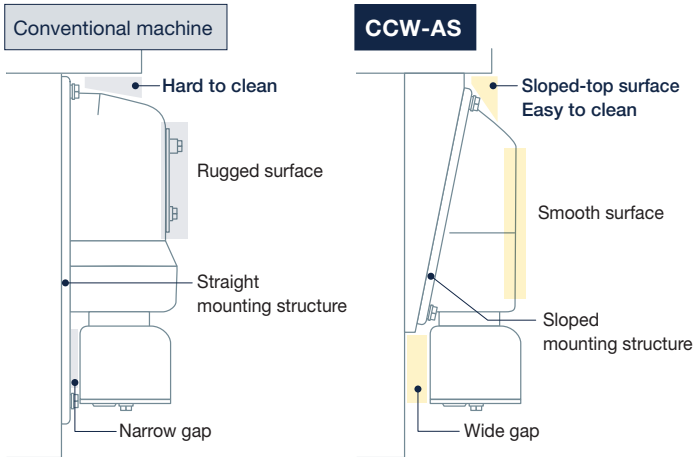

Easily removable hoppers

The hopper's new design makes them easily detachable. The mounting position is clearly identified to guide operators for correct remounting. This minimizes the weighing error as well as the risk of damaging products due to incorrect remounting.

User friendly design

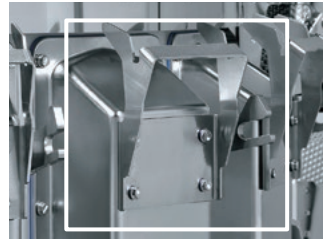

Pool hopper hanger

The new hopper hanger design prevents incorrect remounting.

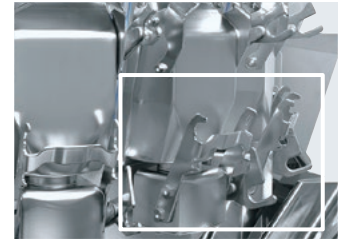

Weigh hopper hanger

A new stay bar smooths detaching.

Advanced HMI

User friendly operation by smartphone-like HMI

Smartphone-like interface with intuitive graphical icons enable easy operation for anyone.

Intuitive operability

Reduced human error



Advanced ecological model

Save energy and reduce the running cost

The CCW-AS uses 20% less power than the CCW-RV due to new hopper motor drive programming.

Noiseless feeder drive (-16.5 dB compared with CCW-RV)

New feeder (XRF-7) improves working environment by reducing noise of feeder drive.

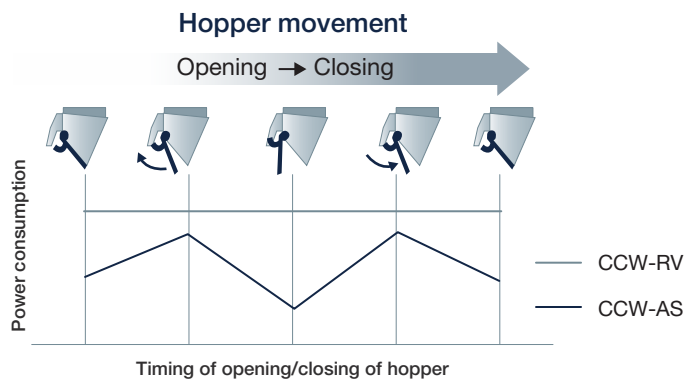

Multihead Weigher

Weighing range : medium capacity type



Dynamic type



Dustproof construction*5
SS type



Waterproof construction*5*6
WP type

CCW-AS-214W-*/15 -SS/WP
CCW-AS-214W-*/20 -SS/WP
CCW-AS-214W-*/30 -SS/WP

	CCW-AS-214W-*/15-SS CCW-AS-214W-*/15-WP	CCW-AS-214W-*/20-SS CCW-AS-214W-*/20-WP	CCW-AS-214W-*/30-SS CCW-AS-214W-*/30-WP
Weighing range	15-500g / 45-1000g		
Weighing volume (MAX)*1	15: 2500cc	20: 3000cc	30: 4500cc
Weighing speed (MAX)*2	210wpm		180wpm

Dimensions (Unit: mm)

CCW-AS-214W-*/15 -SS/WP

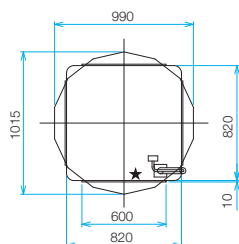

CCW-AS-214W-*/20 -SS/WP
CCW-AS-214W-*/30 -SS/WP

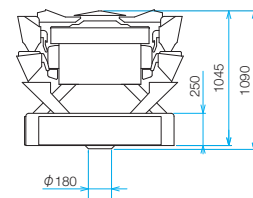
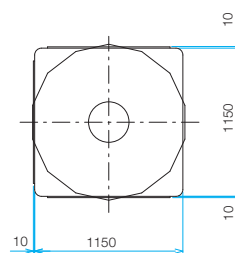
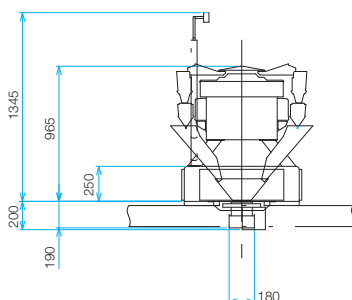

These dimensions show standard model

Standard specification

Model	CCW-AS-214W-□/◇/□ (□=Number of discharge ◇=Hopper capacity □=Environment-resistance)		
	CCW-AS-214W-*/15-SS CCW-AS-214W-*/15-WP	CCW-AS-214W-*/20-SS CCW-AS-214W-*/20-WP	CCW-AS-214W-*/30-SS CCW-AS-214W-*/30-WP
Performance			
Weighing range	15-500g / 45-1000g		
Weighing volume (MAX)*1	15: 2500cc 20: 3000cc 30: 4500cc		
Weighing speed (MAX)*2	210wpm		180wpm
Weighing accuracy*2*3	0.5-1.0g (400g) / 1.0-2.0g (800g)		
Maximum weighing per head*3	400g / 800g		
Minimum graduation*3	0.1g / 0.2g		
Hopper capacity	15: 1500cc 20: 2000cc 30: 3000cc		
Display	15.6" sized color LCD touch panel		
Number of presets	500 items		
Specification			
Power supply*4	1-phase AC200-240V 1.1kVA (5.4A in case of AC200V) 50/60Hz or 1-phase AC380V/400V/415V/460V/480V 1.1kVA (2.9A in case of AC380V) 50/60Hz		
Air consumption (only for WP)	110ℓ/min (ANR) 0.02Mpa		
Machine material	Stainless steel		
Ingress protection	SS: IP 50*5 WP: IP69K*5*6		
Operational environment	Temperature	0-40°C	
	Humidity	35-85%RH (without condensation)	
	Elevation*7	Lower than 2000 meters above sea level	
Machine weight	Approx. 400kg		Approx. 550kg

*1) Max weighing range per discharge *2) Depends on product shape, product density, target weight, etc. *3) Depends on weighing range

*4) Voltage fluctuation: within ±10% Power consumption depends on weighing conditions, please contact us for more details *5) Based on internal test results

*6) Protection against high-pressure washing is evaluated at the time the product is shipped; aging evaluation is not included *7) Please contact us if the elevation of the installation site exceeds 2000m

Multihead Weigher

Weighing range : medium capacity type

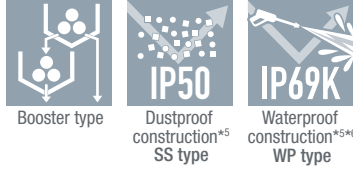

CCW-AS-216B-*/15 -SS/WP
CCW-AS-216B-*/20 -SS/WP
CCW-AS-216B-*/30 -SS/WP

	CCW-AS-216B-*/15-SS CCW-AS-216B-*/15-WP	CCW-AS-216B-*/20-SS CCW-AS-216B-*/20-WP	CCW-AS-216B-*/30-SS CCW-AS-216B-*/30-WP
Weighing range	15-500g / 45-1000g		
Weighing volume (MAX) ^{*1}	15: 2500cc	20: 3000cc	30: 4500cc
Weighing speed (MAX) ^{*2}	120wpm x 2		110wpm x 2

Dimensions (Unit: mm)

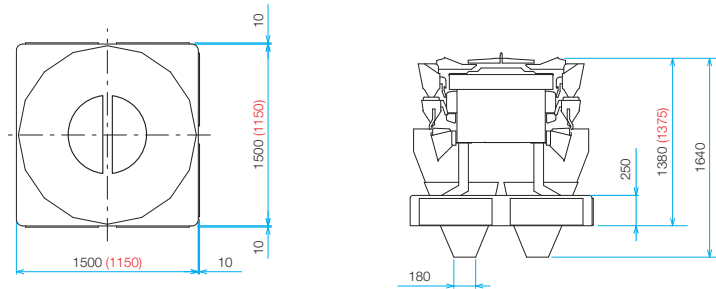

* Dimensions in red are for 15 size.

These dimensions show standard model

Standard specification

Model	CCW-AS-216B-■/◇/□ (■=Number of discharge ◇=Hopper capacity □=Environment-resistance)		
	CCW-AS-216B-*/15-SS CCW-AS-216B-*/15-WP	CCW-AS-216B-*/20-SS CCW-AS-216B-*/20-WP	CCW-AS-216B-*/30-SS CCW-AS-216B-*/30-WP
Performance			
Weighing range	15-500g / 45-1000g		
Weighing volume (MAX) ^{*1}	15: 2500cc 20: 3000cc 30: 4500cc		
Weighing speed (MAX) ^{*2}	120wpm x 2		110wpm x 2
Weighing accuracy ^{*2*3}	0.5-1.0g (400g) / 1.0-2.0g (800g)		
Maximum weighing per head ^{*3}	400g / 800g		
Minimum graduation ^{*3}	0.1g / 0.2g		
Hopper capacity	15: 1500cc 20: 2000cc 30: 3000cc		
Display	15.6" sized color LCD touch panel		
Number of presets	500 items		
Specification			
Power supply ^{*4}	1-phase AC200-240V 1.4kVA (6.7A in case of AC200V) 50/60Hz or 1-phase AC380V/400V/415V/460V/480V 1.4kVA (3.6A in case of AC380V) 50/60Hz		
Air consumption (only for WP)	110ℓ/min (ANR) 0.02Mpa		
Machine material	Stainless steel		
Ingress protection	SS: IP 50 ^{*5} WP: IP69K ^{*5*6}		
Operational environment	Temperature	0—40°C	
	Humidity	35—85%RH (without condensation)	
	Elevation ^{*7}	Lower than 2000 meters above sea level	
Machine weight	Approx. 700kg		Approx. 750kg

*1) Max weighing range per discharge *2) Depends on product shape, product density, target weight, etc. *3) Depends on weighing range

*4) Voltage fluctuation: within ±10% Power consumption depends on weighing conditions, please contact us for more details *5) Based on internal test results

*6) Protection against high-pressure washing is evaluated at the time the product is shipped; aging evaluation is not included *7) Please contact us if the elevation of the installation site exceeds 2000m

Multihead Weigher

Weighing range : medium capacity type



Dynamic booster type



Dustproof construction*5
SS type

Oval type

CCW-AS-218WB-/20-SS-OVL**
CCW-AS-218WB-/30-SS-OVL**

	CCW-AS-218WB-**/20-SS-OVL	CCW-AS-218WB-**/30-SS-OVL
Weighing range	15-500g / 45-1000g	
Weighing volume (MAX)*1	20: 3000cc	30: 4500cc
Weighing speed (MAX)*2	140wpm x 2	120wpm x 2

Dimensions (Unit: mm)

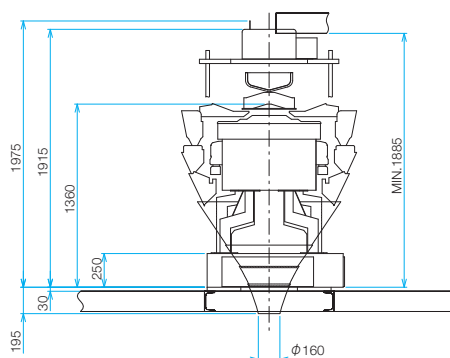
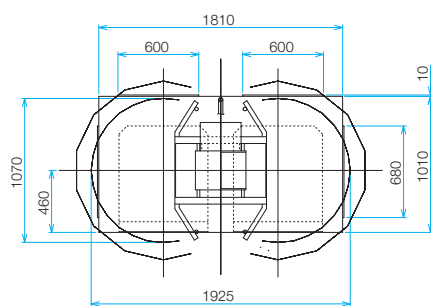

These dimensions show standard model

Standard specification

Model	CCW-AS-218WB- <input type="checkbox"/> / <input type="checkbox"/> -OVL (<input checked="" type="checkbox"/> =Number of discharge <input type="checkbox"/> =Hopper capacity <input type="checkbox"/> =Environment-resistance)	
	CCW-AS-218WB-**/20-SS-OVL	CCW-AS-218WB-**/30-SS-OVL
Performance		
Weighing range	15-500g / 45-1000g	
Weighing volume (MAX)*1	20: 3000cc	30: 4500cc
Weighing speed (MAX)*2	140wpm x 2	120wpm x 2
Weighing accuracy*2*3	0.5-1.0g (400g) / 1.0-2.0g (800g)	
Maximum weighing per head*3	400g / 800g	
Minimum graduation*3	0.1g / 0.2g	
Hopper capacity	20: 2000cc	30: 3000cc
Display	15.6" sized color LCD touch panel	
Number of presets	500 items	
Specification		
Power supply*4	1-phase AC200-240V1.4kVA (7.0A in case of AC200V) 50/60Hz or 1-phase AC380V/400V/415V/460V/480V 1.4kVA (3.6A in case of AC380V) 50/60Hz	
Air consumption (only for WP)	125ℓ/min (ANR) 0.02Mpa	
Machine material	Stainless steel	
Ingress protection	IP 50*5	
Operational environment	Temperature	0—40°C
	Humidity	35—85%RH (without condensation)
	Elevation*6	Lower than 2000 meters above sea level
Machine weight	Approx. 950kg	

*1) Max weighing range per discharge *2) Depends on product shape, product density, target weight, etc. *3) Depends on weighing range

*4) Voltage fluctuation: within ±10% Power consumption depends on weighing conditions, please contact us for more details

*5) Based on internal test results *6) Please contact us if the elevation of the installation site exceeds 2000m

The information in this catalog is current as of February 10, 2023.
The company name and product name described in this catalog are registered trademarks.
The machine color in this catalog may differ from the actual machine.
The machine appearance and specifications described in this catalog are subject to change without any notification.



ISHIDA CO., LTD. www.ishida.com

44 Shogoin Sannocho, Sakyo-ku,
Kyoto, 606-8392, Japan
Tel: +81 (0)75 751 1618 Fax: +81 (0)75 751 1634



HEAT AND CONTROL, INC.

www.heatandcontrol.com
21121 CABOT BLVD. HAYWARD, CA 94545-1132 USA
info@heatandcontrol.com